

TOPKIT G3/28B

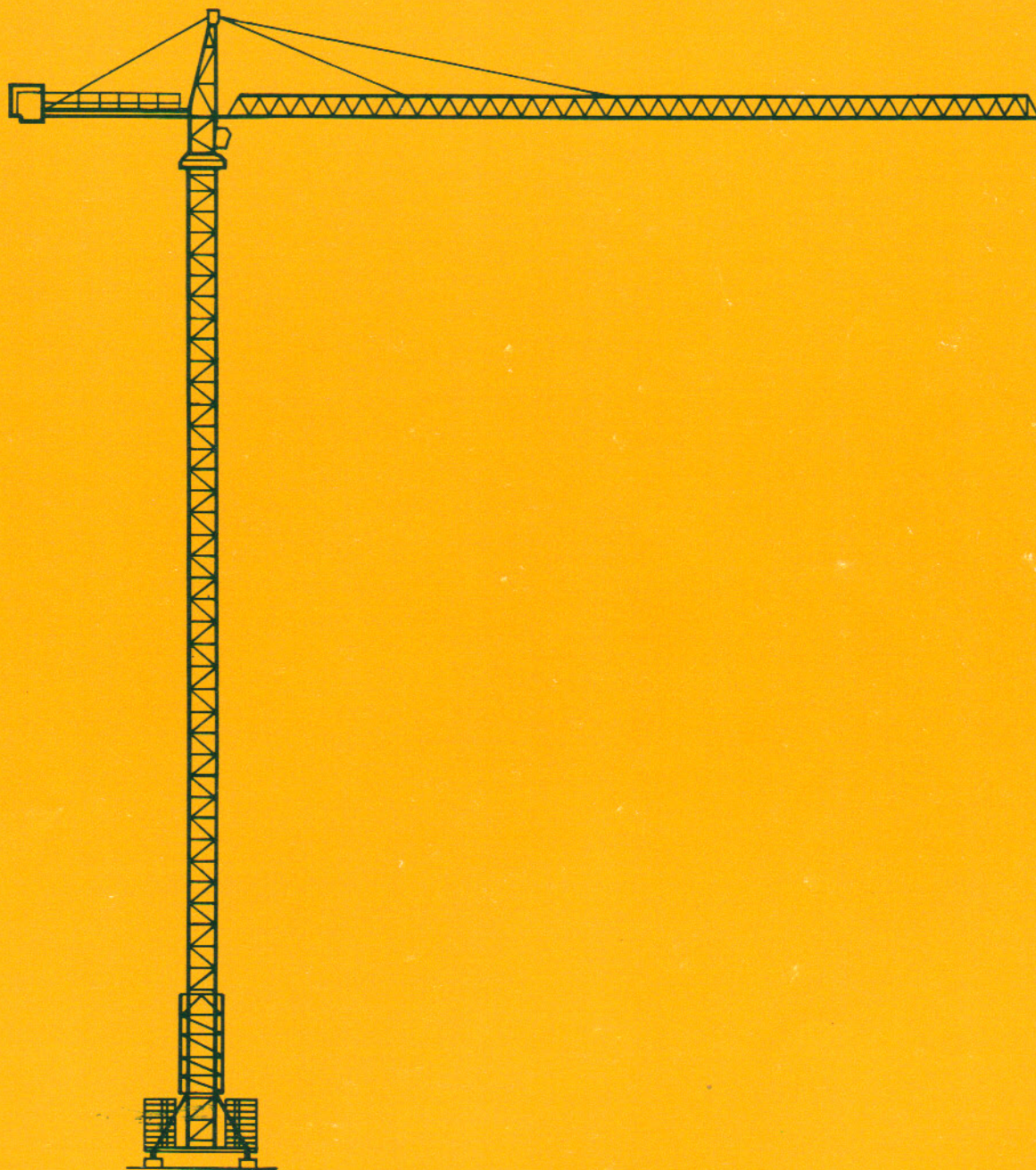

TOPKIT G3/28B

Potain



Potain TOPKIT G3/28B

Cotes Abmessungen Dimensions Dimensiones

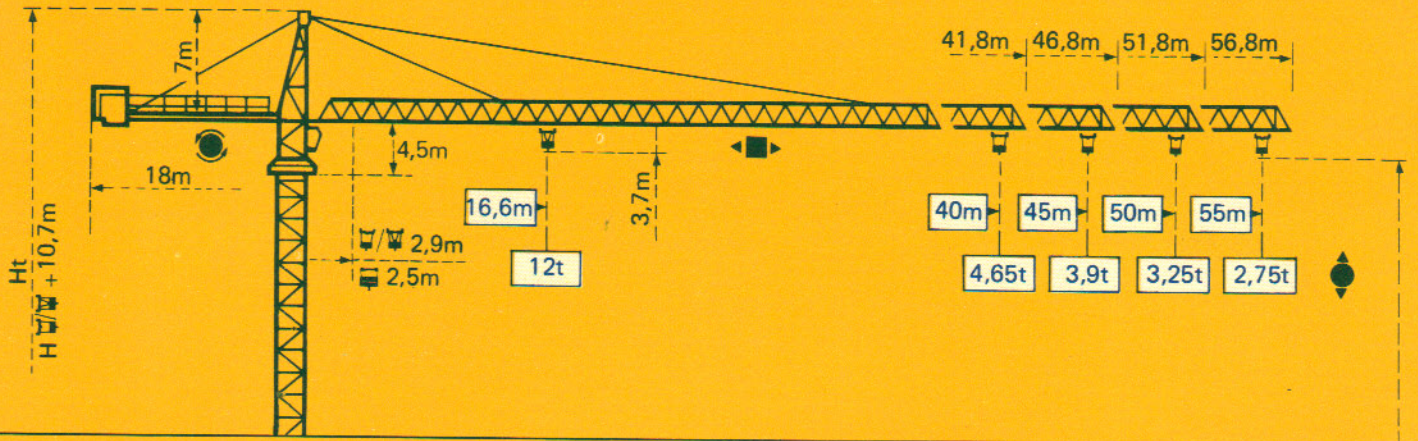

Mâtère Mast Mast Mástil
 ▧ 2 m x 2 m

PA 664

Mâtère Mast Mast Mástil
 ▧ 2 m x 2 m

VA 664

$$H_{\square} = H_{\square/\square} + 1m$$

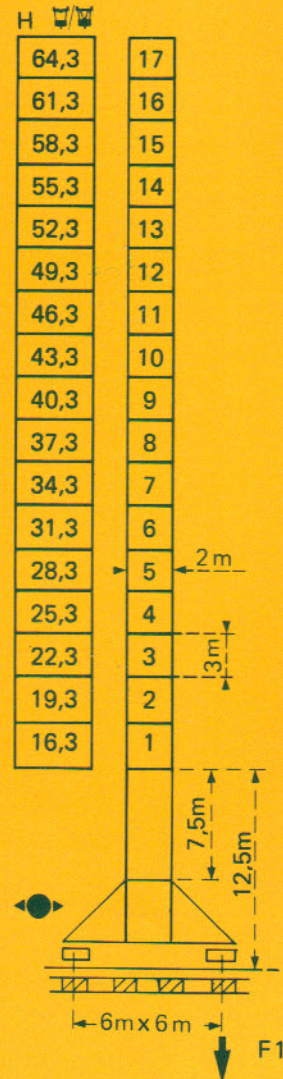
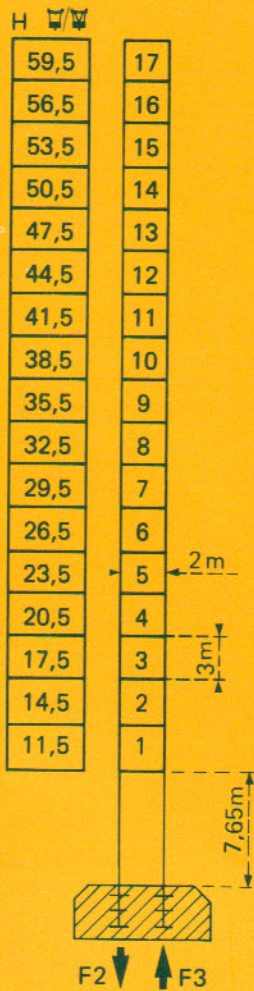

F = Réactions Eckdrücke Reactions Reacciones



F2	● 129 t	■ 183 t
F3	● 86 t	■ 145 t
	69 t	



F1	● 95 t	■ 125 t
	81 t	

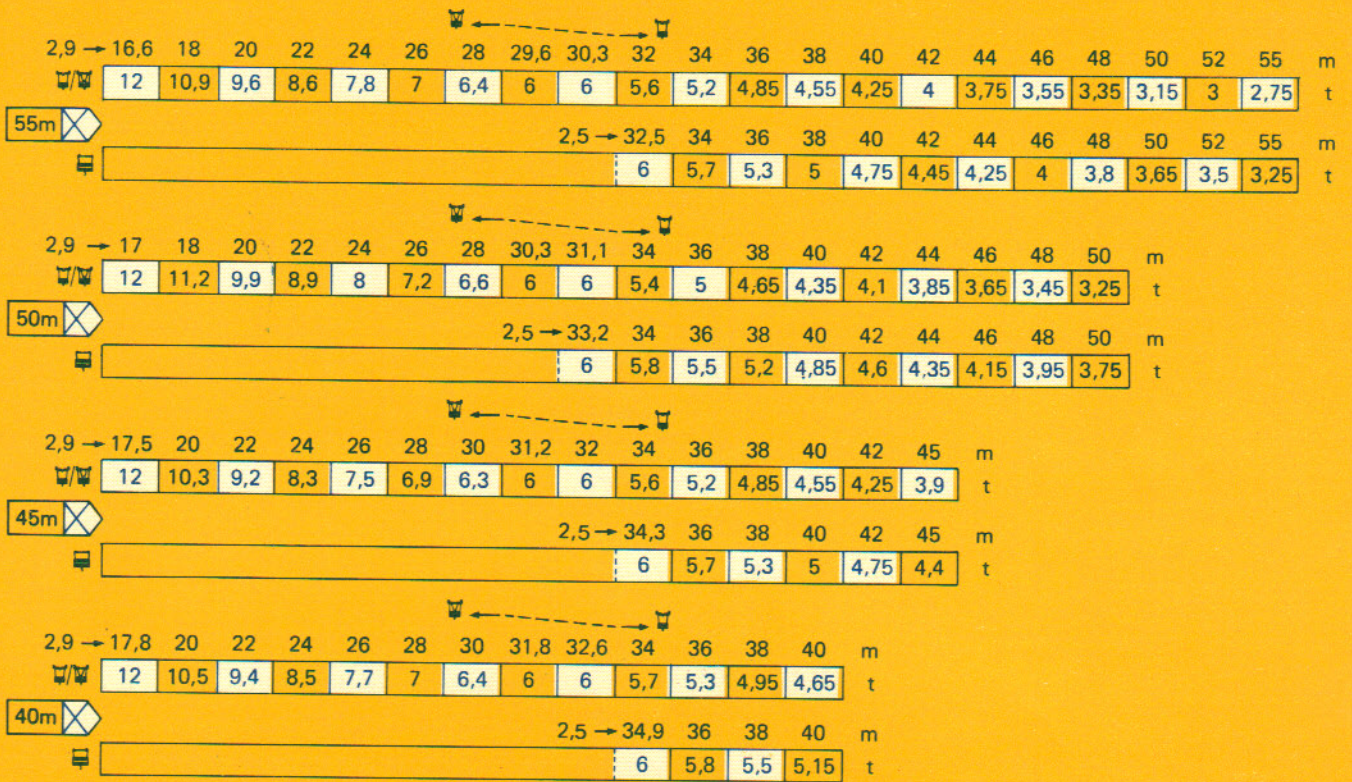

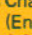
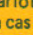

Courbes de charges Lastkurven Load curves Curvas de cargas

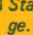



 Flèche Ausleger Jib Flecha

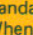

 Chariot standard 2/4 brins.
(En cas d'utilisation  déduire 0,2 t aux charges ).
 Chariot optionnel 2 brins uniquement.

 Standardlaufkatze 2/4 Stränge.
(Bei Einsatz von  ist 0,2 t der Lasten von  abzuziehen.
 Laufkatze in Sonderausführung mit nur 2 Strängen.

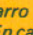
 Standard trolley 2/4 fall.
(When using  subtract 0,2 t from the loads ).
 Optional trolley 2 fall only.

 Carro standard 2/4 ramales.
(En caso de utilización  quitar 0,2 t de las cargas ).
 Carro opcional en 2 ramales solamente.

Implantations spéciales Einsatzmöglichkeiten Special mounting possibilities Instalaciones especiales

Nous consulter
Auf Anfrage
Consult us
Consultarnos

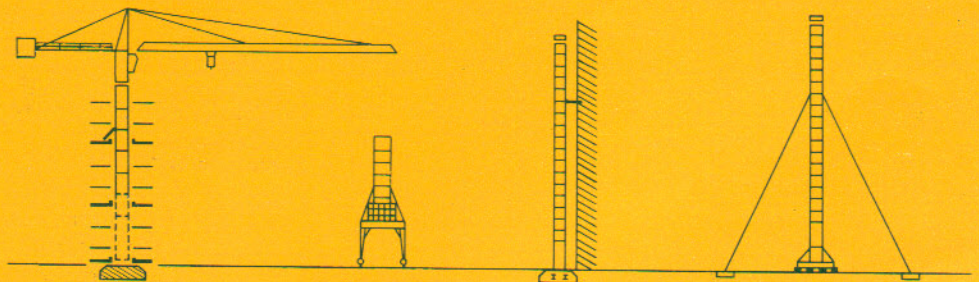

H > H maxi : nous consulter

- En service
- Hors service

 A vide sans lest avec flèche et hauteur maximum.

H > H maxi : Auf Anfrage

- In Betrieb
- Ausser Betrieb

 Ohne Last und Ballast mit Maximalausleger und Maximalhöhe.

H > H maxi : consult us

- In service
- Out of service











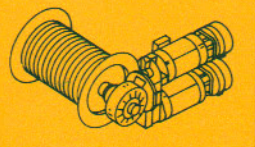





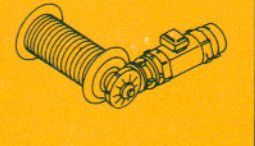



 Without load and ballast with longest jib and maximum height.

H > H máxi : Consultarnos

- En servicio
- Fuera de servicio

 Sin cargas, sin lastre con flecha y altura máxima.

Mécanismes Antriebe Mechanisms Mecanismos

					m/min	t		ch-PS hp	kW	
Levage Heben Hoisting Elevación		55 RCS 30 	   	34 68 17 34	6 3 12 6	365m > 365m *	55	40,5		
		33 PC 30 	       	3,5 19 38 1,75 9,5 19	6 6 3 12 12 6	408m > 408m *	33	24		
Distribution - Katzfahren Trolleying - Distribución			6 DPC 4	7,5 30 60				6	4,4	
Orientation - Schwenken Slewing - Orientación			OMD 55	0 → 0,8 tr/min U/min-rpm				2 x 8	2 x 5,9	
Translation Kranfahren Travelling Traslación	▲ Standard Standard Standard Standard	VA 664 	▲ RT 443 A1 2 V	15 - 30				4 x 5	4 x 3,7	
	▲▲ Changement de poste Umsetzen Repositioning Cambio de sitio		▲▲ RT 426 C1	16				2 x 6,5	2 x 4,8	
	▲▲▲ Rapide Schnell Fast Rápida	R ≥ 12m	▲▲▲ RC 646 AR H ≤ 43,3m	10 - 50				4 x 6,8	4 x 5	
Puissance électrique nécessaire Anschlusswert Necessary electric power Potencia electrica necesaria		380 V 50 HZ 	Réseau - Netzstrom - Mains supply - Red				RCS : 75kVA PC : 60kVA			
			Groupe électrogène Stromaggregat Generator set Grupo electrogeno				*			

* Nous consulter - Auf Anfrage - Consult us - Consultarnos

 **Potain**

18, rue de Charbonnières B.P 173 - F 69130 ECULLY
Tél. (7) 833.81.81 Téléx 330 179
EXPORT. 89 Av. du Pdt Roosevelt - CHEVILLY - LARUE
F 94150 RUNGIS - Tél. (1) 687.22.23 - Téléx 270001
POTAIN GmbH - D 6082 MÖRFELDEN - WALLDORF
Nordendstr. 79-87 - Postfach 420 - Tel. (6 105) 5091 - Telex 4 185745
POTAIN SUISSE S.A. - CH 5115 MÖRIKEN WILDEGG
Tel. 64.53.19.91 - Telex 68294

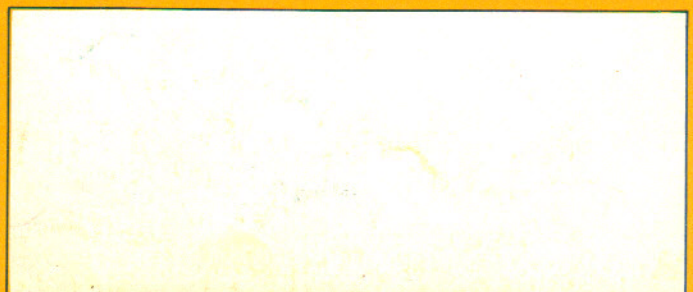

modifications réservés - Änderungen vorbehalten - Subject to modification - Modificaciones reservadas
 Ref. 8109 FAH 2
 Printed in France